

# SLP Laptop - Enable BitLocker Disk Encryption

## SLP Laptop - Enable BitLocker Disk Encryption

Some time after connecting Windows 11 to your school account, you'll receive applications and also a prompt to enable BitLocker.

1. You will see a notification in the notification tray area in the bottom right area of your desktop. Click the **Encryption needed** message to launch the encryption wizard. The select **I don't have any other disk encryption software installed, encrypt all my disks** and then click **Yes**.

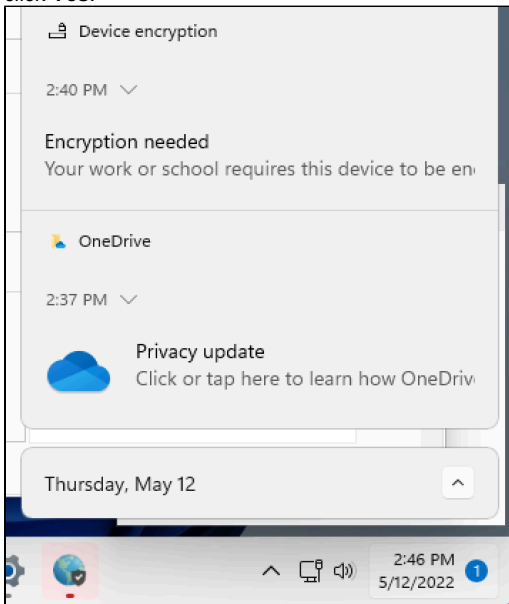

2. Alternatively you can do a Windows search for BitLocker and select **Manage BitLocker**. Then click **Turn on BitLocker**.

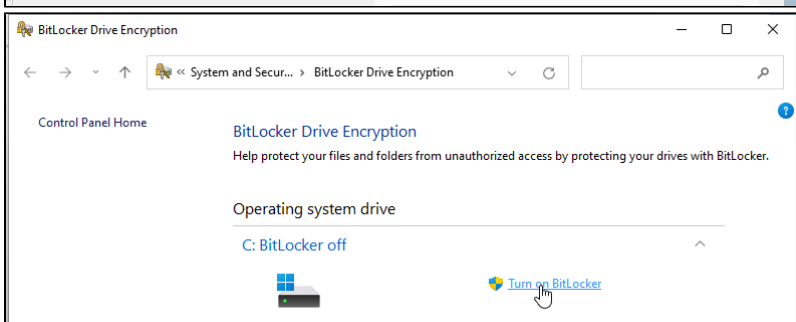
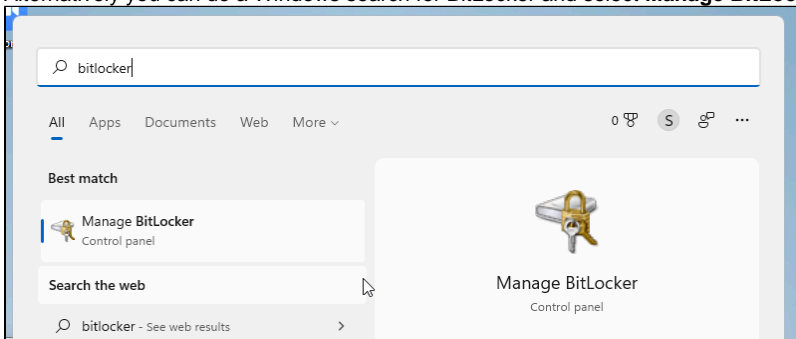

3. When prompted to save the recovery key, choose **Save to your Azure AD account**. If you want to save the recovery key in an additional location, you can also save it to a file on a external drive or print the recovery key. When done, click next.

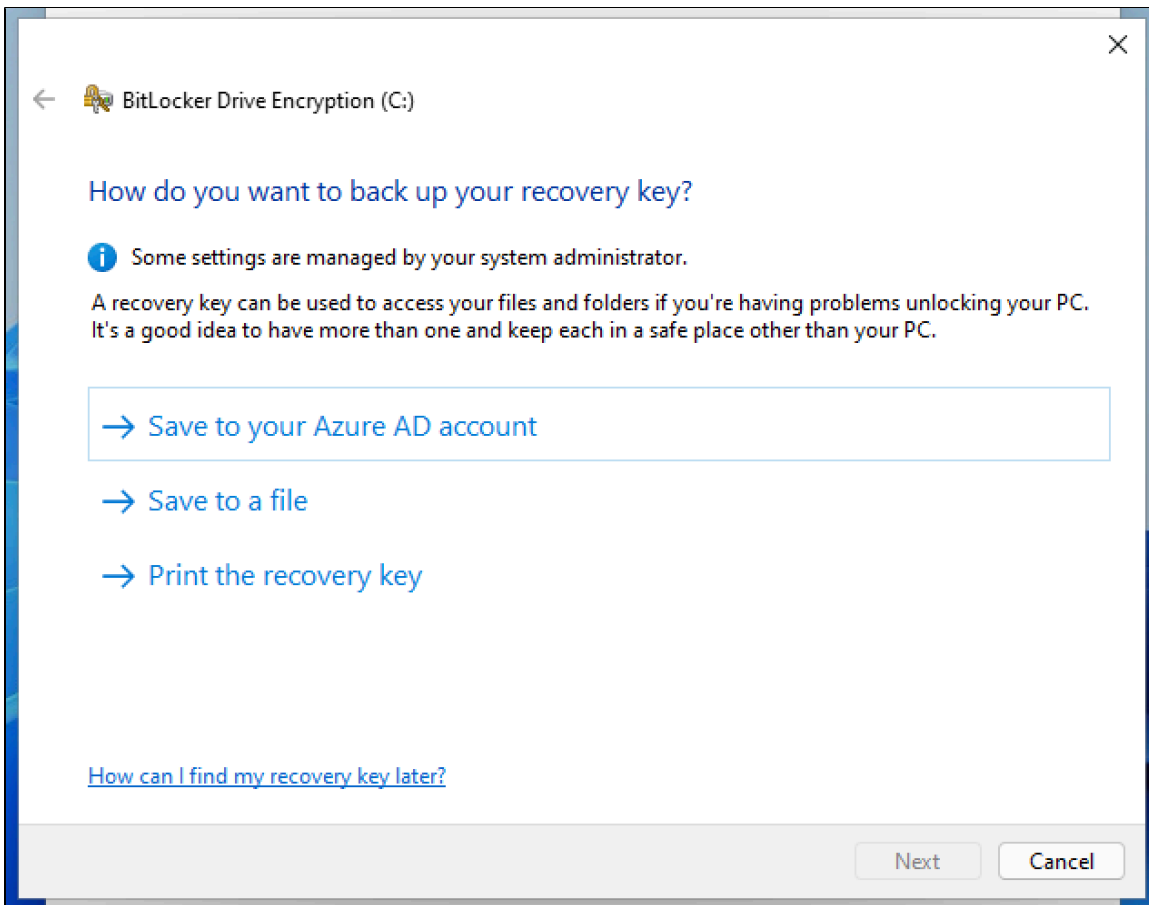

4. Choose to **Encrypt used disk space only** and then click Next.

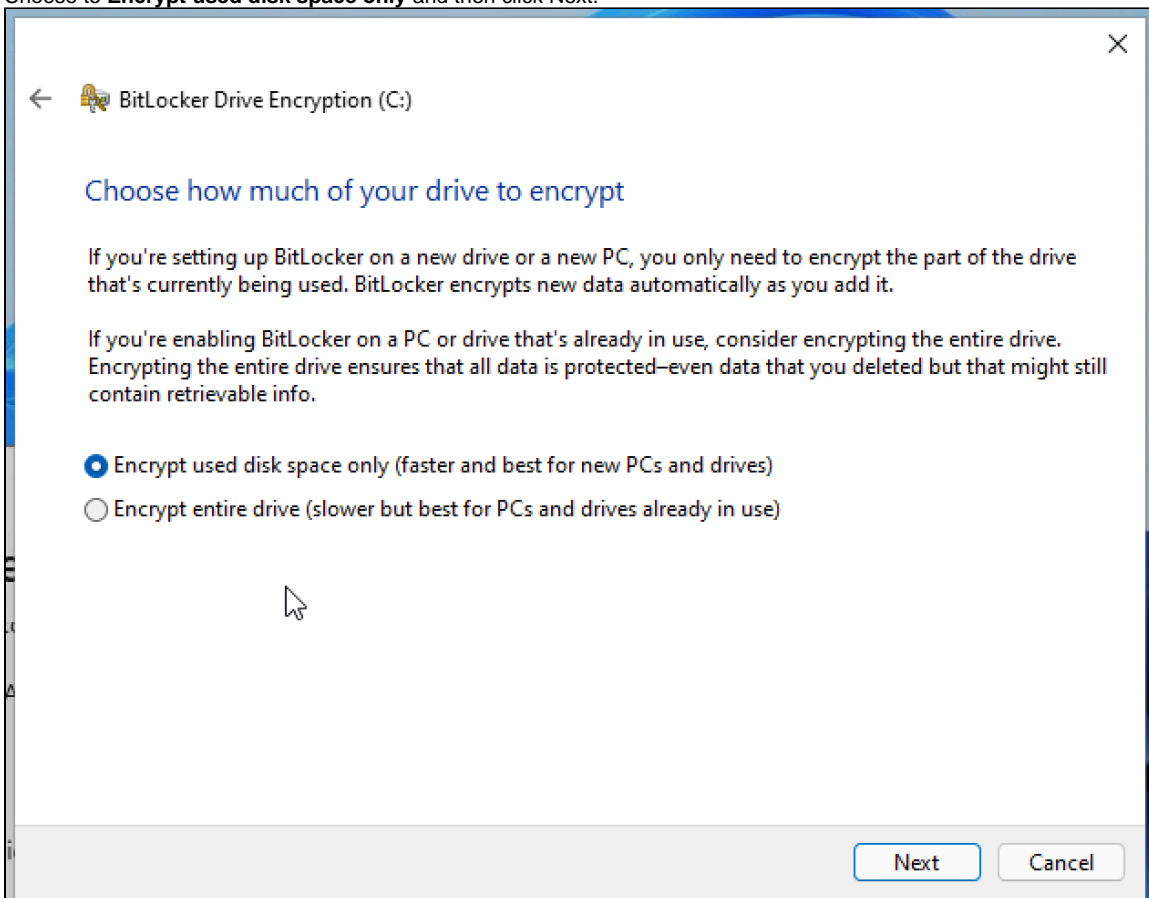

5. When asked if you, "Are ready to encrypt this drive?", click **Start Encrypting**. Drive encryption should only take a few minutes.

This video demonstrates the above steps for enabling BitLocker disk encryption.