

Code42 (CrashPlan) 8.6.x for macOS - Installation

Code42 (CrashPlan) 8.6.x for macOS - Installation



CrashPlan and Code42 are the same application/service. Crashplan was renamed Code42 after it was sold, then renamed again back to CrashPlan after it was sold again. Which name you see in the product, filenames, or paths depends on what version you are using. For the purposes of this documentation, the names are used interchangeably and refer to the same product.

The new vendor website for Crashplan is: <https://www.crashplan.com/>

On this page:

[Summary](#)
[Step-by-step Instructions](#)
[More Information](#)
[See Also](#)

Summary

- Accept the default choices all through the installer.

Step-by-step Instructions



Please note that the file name you have downloaded may vary based on the version available at the time of download

1. Get the [Code42 Installer](#) from the IS&T Software Grid. ([Certificates](#) required.)

Result: The file containing the Code42 installer downloads as something similar to "Code42Crashplan_8.6.0_Mac_MIT.dmg".

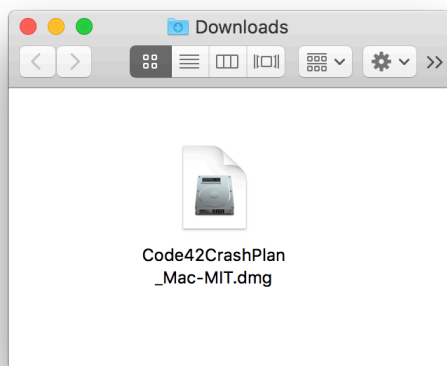

2. Open the disk image file and find the installer named "**Install Code42 CrashPlan.pkg**".

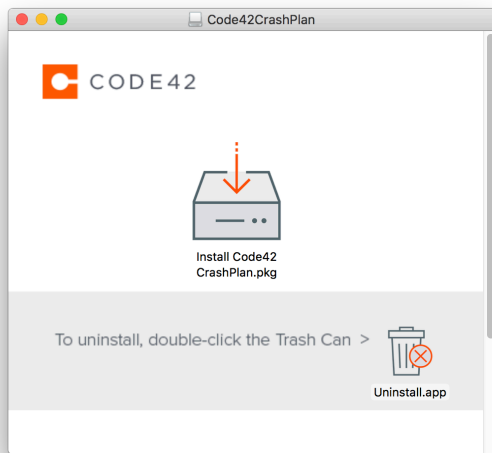

3. Double-click the **"Install Code42 CrashPlan.pkg"** package to start the installation.
Result: The installer starts, and shows a Welcome window.

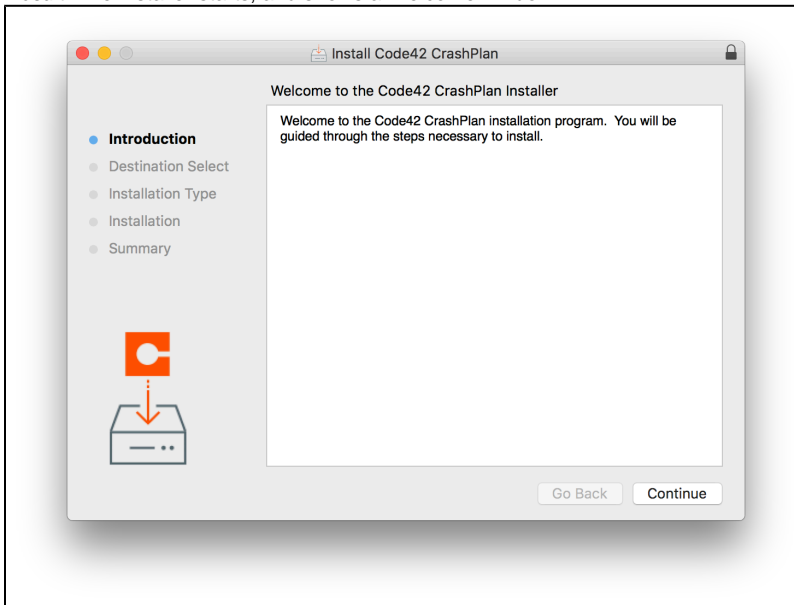

4. Click Continue.
Result: You are prompted to select an installation type.

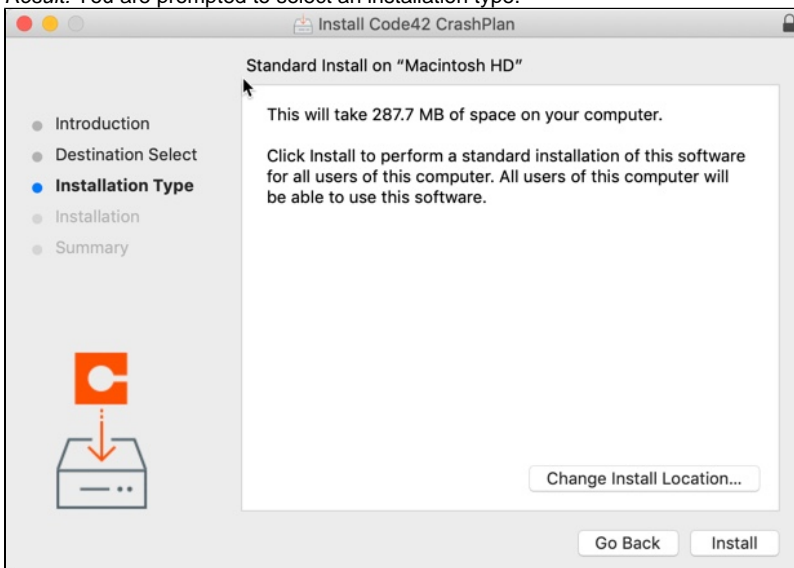

5. Click **Install**

Result: You are prompted to enter a Macintosh administrator username and password.

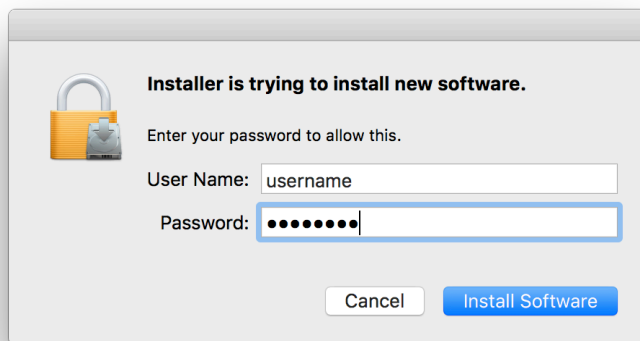

6. Enter your Macintosh administrator username and password, and click **Install Software**.

Result: Code42 will now install. A confirmation screen tells you that the installation was successful. At the same time, the Code42 program will start.

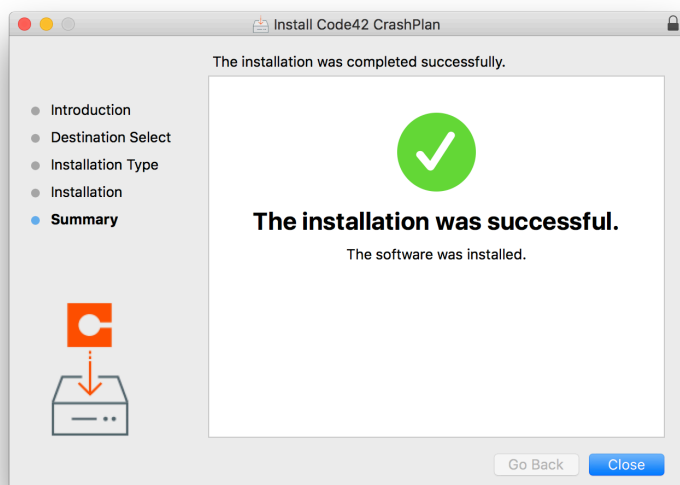

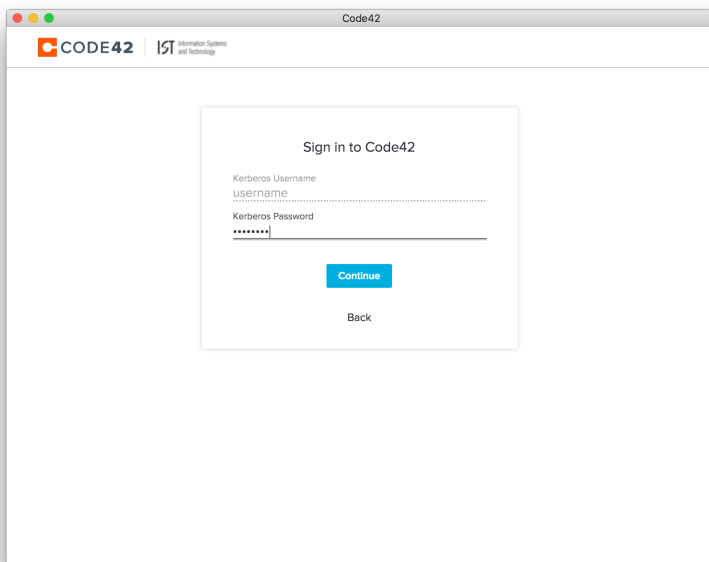

7. Click **Close** to exit the Code42 installer.

8. The Code42 program will open. Enter your **MIT email address** click **Continue** then enter your **Kerberos Password** (if required) and click **Continue** You may also be asked to authenticate with MIT Touchstone.

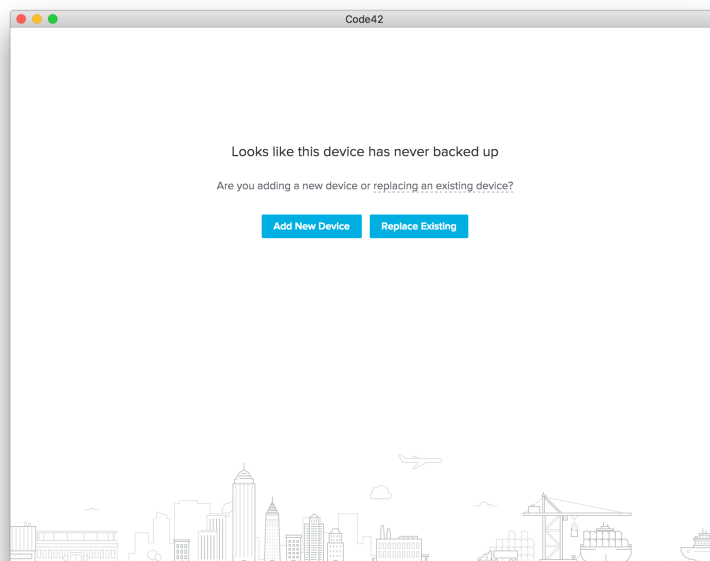

- a. You will have to choose whether the computer is setup as **new device** or to **replace any existing device**. The Code42 wizard will walk you through each scenario.



-  **Note:** If you are asked for a server address or certificate, see [CrashPlan \(formerly Code42\) is asking me for a server address and registration key](#)
- b. If this is the first time you've installed CrashPlan, you will be alerted that you need to grant it Full Disk Access.

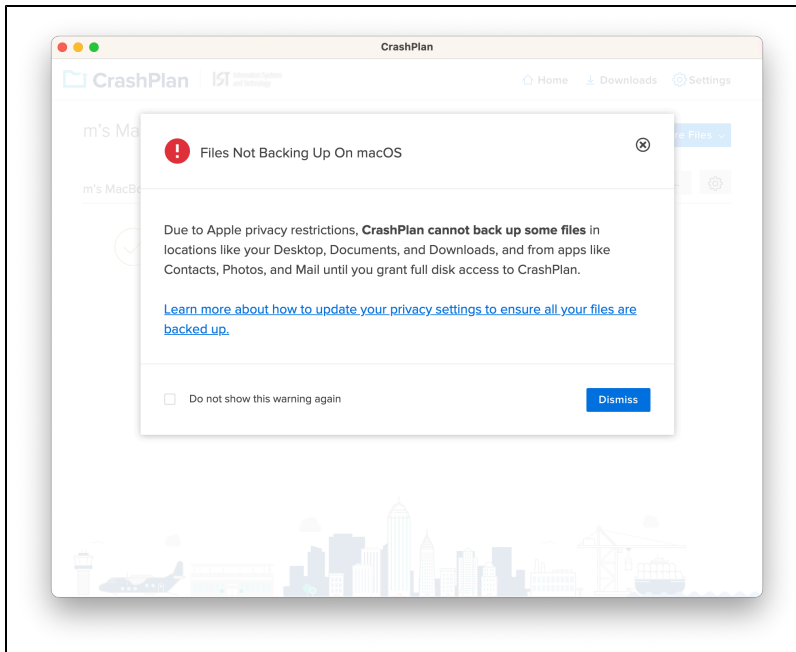

- c. Open System Settings under the Apple menu, and click on Security and Privacy, then "Full Disk Access" on the left.

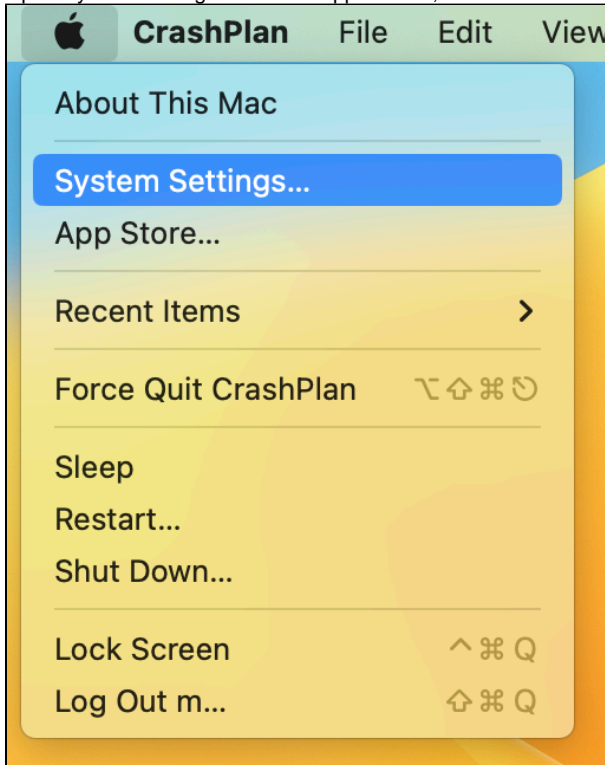

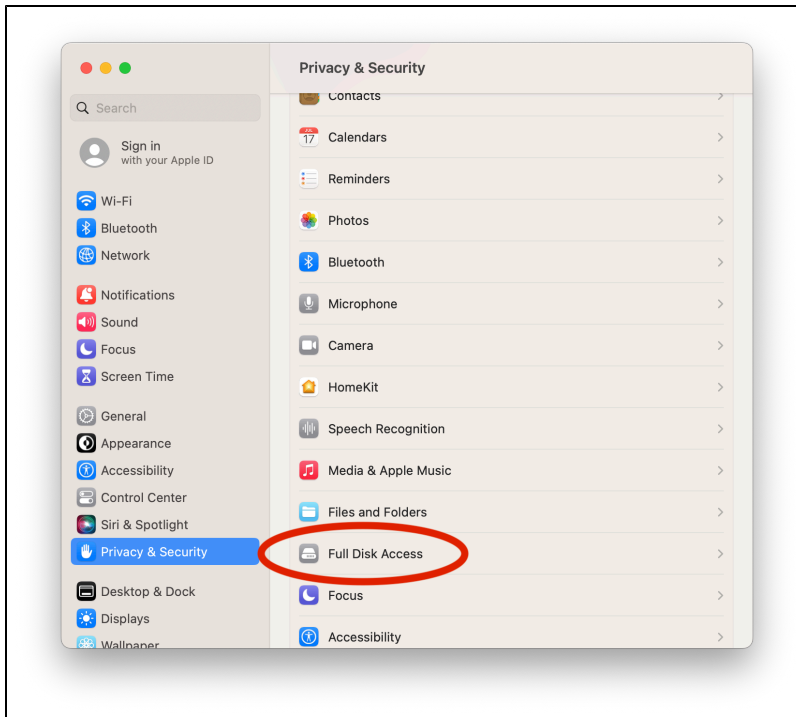



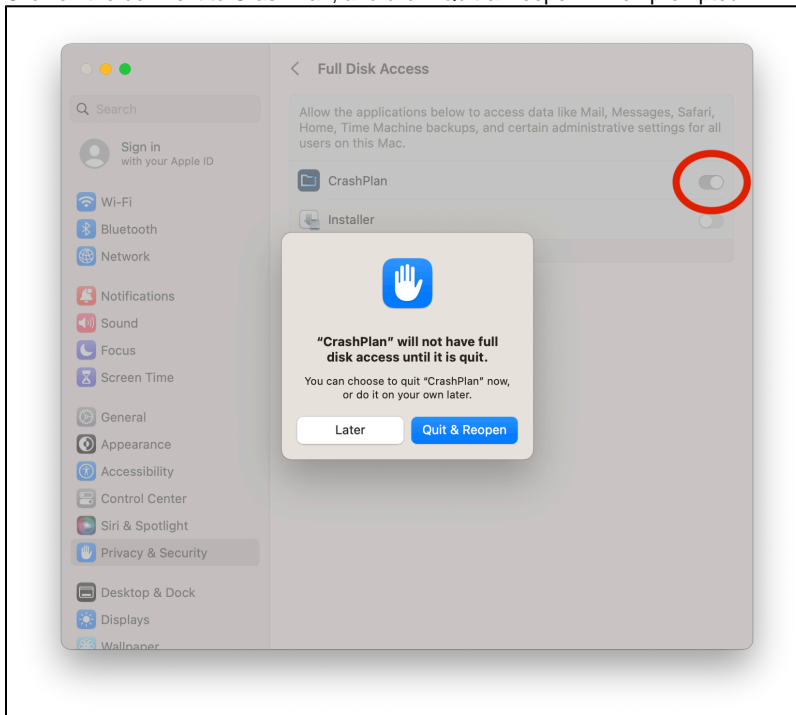

d. Click on the box next to CrashPlan, and click "Quit & Reopen" when prompted.

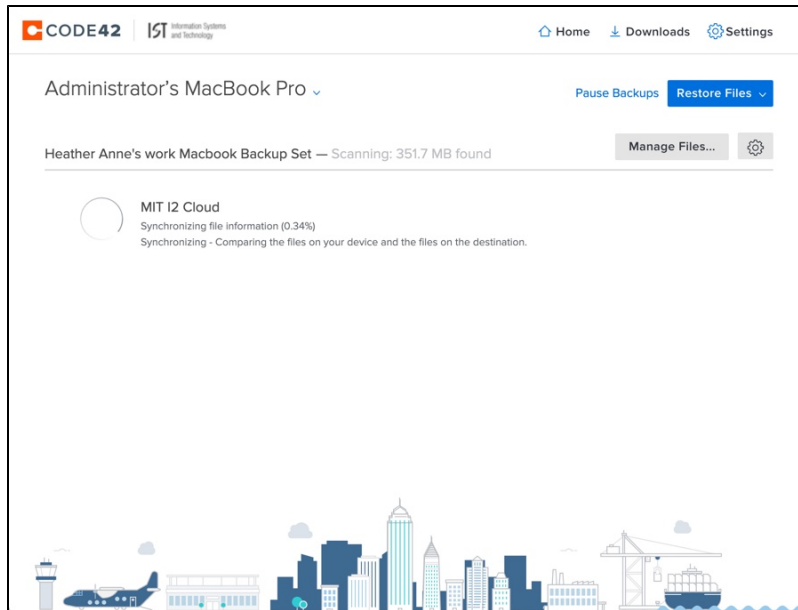

e. You will now be at the Code42 Desktop main screen and your computer should begin to backup.



-  If you have many large files, first time backup may take a few days but subsequent backups should be quicker.
-  Code42 selects every "User" folder on your computer. It also selects some hidden folders; it is normal to see a half-dozen folders on the list, including ones that you haven't seen before.
-  Because Code42 is always working to keep your computer backed up, you may want to pause backups while you are away from campus to avoid using up your personal data limits or incurring any extra fees for overages. To pause Code42's backups, simply click the **pause** button next to the status bar per the image above. Just be sure to turn it back on later!

More Information

- [Code 42's site](#)
- [Code42 \(Formerly CrashPlan\) Landing Page](#)

See Also

- [Code42 \(Formerly CrashPlan\) Landing Page](#)

If you have questions, [contact the IS&T Help Desk](#).