

Install and Connect to the Prisma Access VPN on Android

Install and Connect to the Prisma Access VPN on Android

On this page:

[Install](#)
[Connect](#)
[Disconnect](#)
[See Also](#)

Install

1. Install the [GlobalProtect](#) app from the Google Play Store.

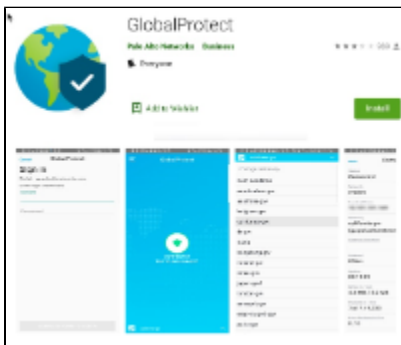

Result: The GlobalProtect App is installed. Continue below to set it up and connect.

Connect

1. Open your GlobalProtect app.
Result: After the splash screen, it will ask you for your portal address.



Click on the thumbnails to open the full images.

2. Enter the address: **gvpn.mit.edu**



3. Click **Connect**.

Result: You will be prompted to authenticate via [Touchstone Authentication](#).

4. Authenticate using [Touchstone Authentication](#).

Result: The VPN will attempt to start a connection. The first time you connect, you will be asked to accept the connection request.

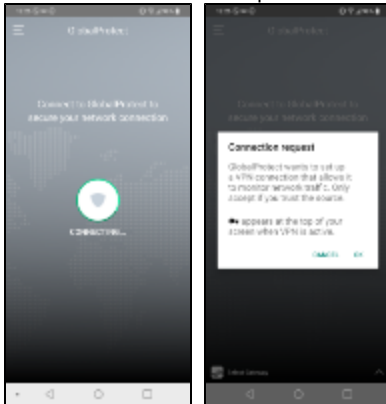

5. Click **OK**

Result: You're connected to MIT GlobalProtect VPN service and may go about your computing activities normally.

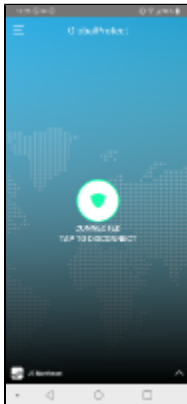

i After the first time you connect, simply open the app and tap the Shield to connect. You may be prompted to authenticate again depending on how long it has been since your last connection.



Disconnect

1. Open the GlobalProtect app.
2. Tap the shield to disconnect.

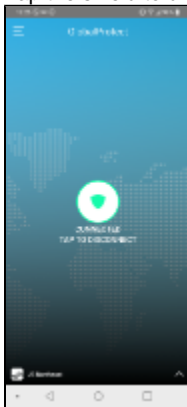

Result: You have been disconnected from the MIT GlobalProtect VPN service.

See Also

- [Prisma Access VPN Landing Page](#)
- [On my Android phone, why do I get a notification that the MIT Prisma VPN is always on? Can I turn it off?](#)