

Working With Content Blocks

Working With Content Blocks

On this page:

[About Blocks](#)
[Viewing Your Theme's Regions](#)
[Repositioning Blocks](#)
[See Also](#)

About Blocks

Blocks are containers for content. Blocks are placed on a page by assigning them to a specific location called a region.

- blocks contain content
- a block is placed in a specific location on a page called a region (e.g., footer, content, sidebar)
- blocks may be moved from one region to another
- regions are built into the theme and may not be changed
- a block which is not placed into any region is disabled and its content will not appear
- blocks may be individually formatted

One of the regions in the default **MIT DLC theme** is named **Footer** and has the *MIT identity* block and the *Shibboleth authentication* (Touchstone Login) block assigned to it. The **Sidebar first** region has no blocks assigned to it. When you are logged in there is a third block in the **Footer** region named *Content Management* which list shortcut links to various overlay, or options pages.

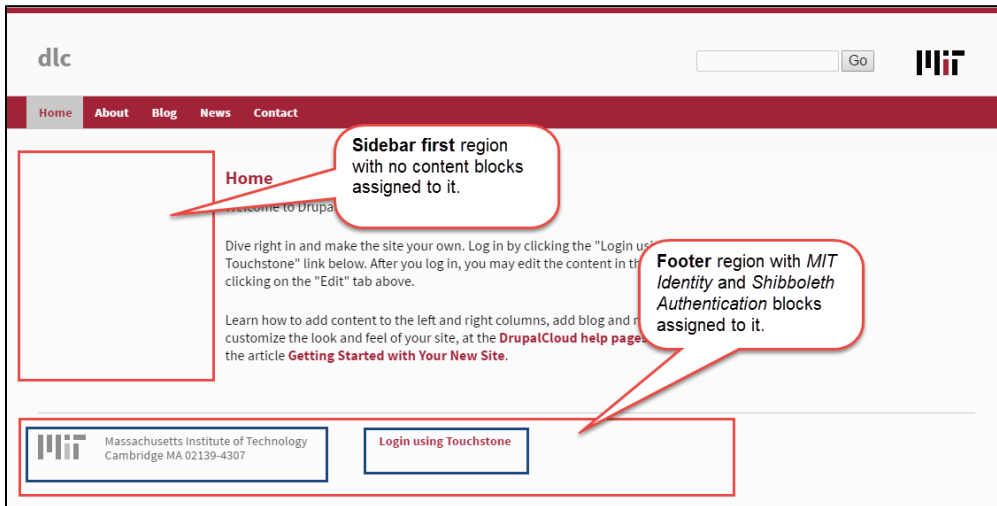

Viewing Your Theme's Regions

1. From the Admin menu click **Structure**, then **Blocks**. Be sure you are looking at your current theme.
2. To see the region locations click *Demonstrate block regions (MIT DLC Theme)*__.

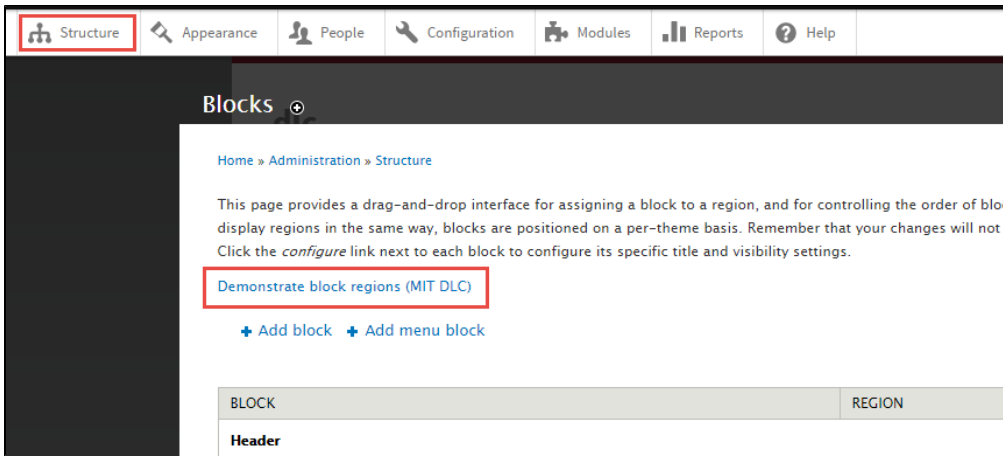

- Each dotted box is a named region into which you can place a block or blocks.

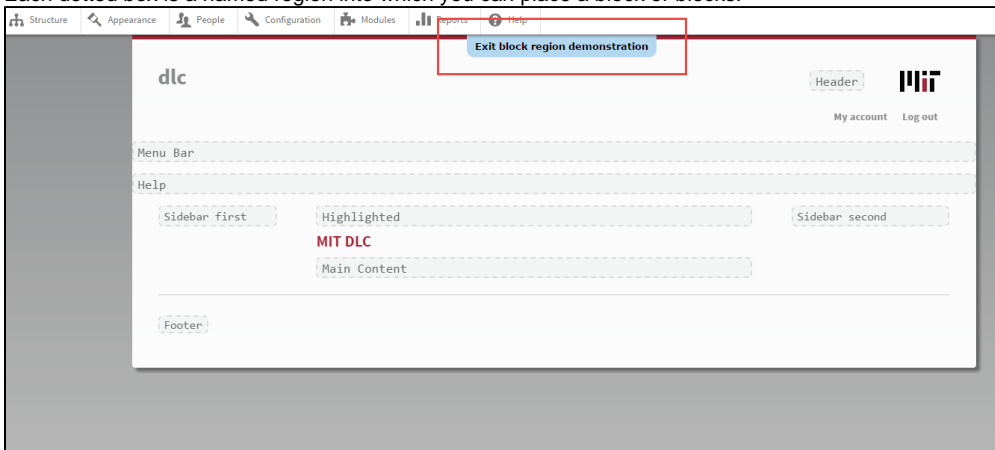

Repositioning Blocks

Notice that all blocks are listed on the *Blocks* overlay screen.. If they are in use (enabled) they are grouped by the region in which they are located. Disabled blocks are located at the bottom of the screen. To the right of the block name is a popup menu listing all the regions.

BLOCK	REGION	OPERATIONS
Header		
+ Search form	Header	configure
Main Content		
+ Main page content	Main Content	configure
Sidebar first		
No blocks in this region		
Sidebar second		
No blocks in this region		
Menu Bar		
+ Main menu	Menu Bar	configure

- To move a block to a different region, choose a the new region from the Regions popup menu.

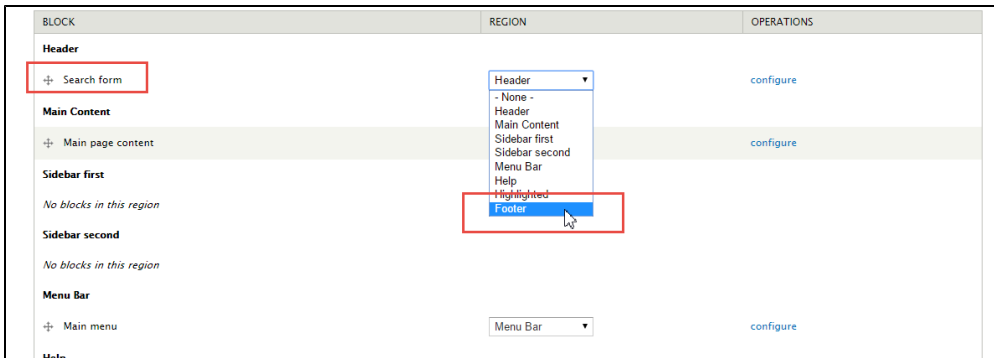

2. To prevent a block from being visible select *None* from the Regions popup menu. It will move to disabled blocks group at the bottom of the list.
3. Click *configure* to work with additional options for a particular block (e.g., determine which pages will show the block or who can edit the block).

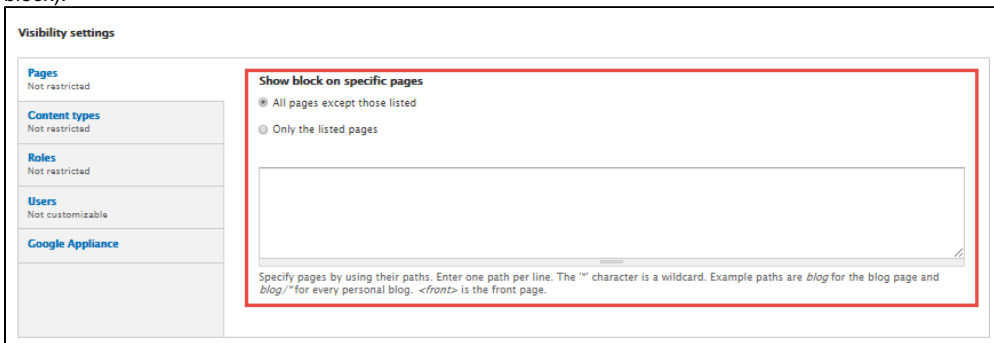

4. To reposition a block within a region drag the cross hair to the left of the block's name up or down.

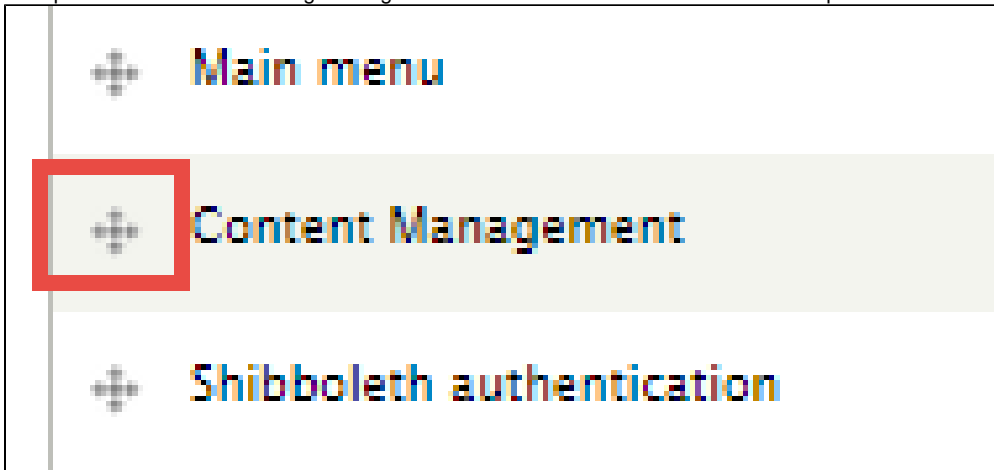

See Also

- [Return to Drupal Cloud Landing Page](#)