

# Drupal Terms

## Drupal Terms

[Return to Drupal Cloud Landing Page](#)

Part of the mystique and learning curve of Drupal is the terminology. Here is a list of the most common terms which are explained in more detail on other pages.

On this page:

- [Key Terms](#)
- [Additional Terms](#)

## Key Terms

Page	A web page is a collection of content which may be static or may be dynamically generated. A page is divided into regions. Regions hold blocks, which hold content.
Theme	A theme is a pre-designed layout for a site. In addition to fonts, colors and other design elements, themes control the page layout through regions and blocks. Drupal Cloud offers a number of themes. The default theme for a new Drupal Cloud site is the MIT DLC theme. You can modify the design of your theme through the Appearance options screen.
Region	A web page in Drupal is divided into regions which allow you to place your content in a particular area of the page.
Block	A block is a collection of content, for example a menu which may be placed into a region. The default menu block is located in the sidebar first region. Blocks are easily moved from region to region.
Node	A node is a unit of content stored in Drupal's database and is accessible through a unique URL. A node may be a page, a blog post, a news article, etc.

In the example shown here, you see the *Main page content* block in *Main Content* region in the middle. You also see content (the MIT logo) and the Touchstone Login block (*Shibboleth authentication*) block in the *Footer* region. The content in each of these regions and blocks are considered to be individual nodes.

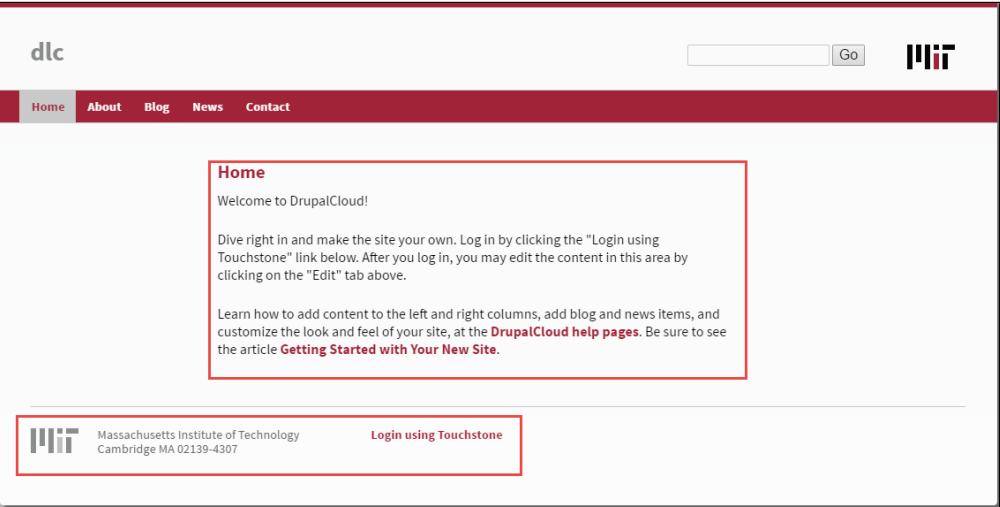

## Additional Terms

Content Type	A content type is a arrangement of related fields. Each content type will always have a title field and several other fields. The type of fields included give the content type its unique character. For example, a Basic page content type has a <i>title</i> and a <i>body</i> field. A News content type has a title and a body field but also a <i>date</i> field. Some content types have already been defined for you to choose from when adding new data to your site. You can also create a new content type if you need to.
--------------	---

<b>Module</b>	A module is an add-on which provides specialized functionality to Drupal. Some modules are already components of Drupal. Others are developed by the user community and made available to you through the Drupal Cloud service.
<b>Role</b>	Roles are account types you can create to specify access rules about what pages and features a specific user type can see or use. Roles are first created and then granted permissions by the site administrator. Then roles are assigned by the site administrator to individual users.
<b>Taxonomy</b>	A taxonomy is a label or tag you create and assign to a node or content type. Taxonomies provide a way to group similar types of information.

[Return to Drupal Cloud Landing Page](#)