

Configure Zoom for iPad

Configure Zoom for iPad

Configure

1. If you have not already done so, [Download Zoom in the Apple App Store](#) and launch the app.
2. Select "Sign in" at the bottom

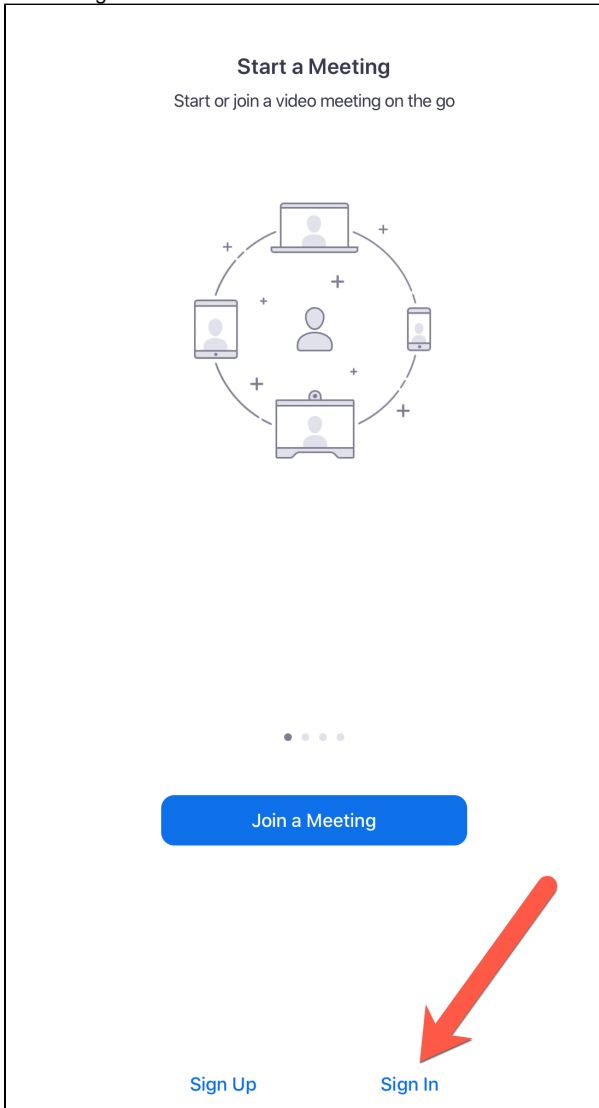

3. Select SSO

Cancel Sign In

Email Address

Password

Sign In

[Forgot password?](#)

OR, SIGN IN WITH

 SSO >

 Google >

 Facebook >

4. Enter "MIT" for Company Domain

✕ Sign In with SSO

[Forgot password?](#)

Enter your company domain

mit .zoom.us

[I don't know the company domain](#)

5. Authenticate with Touchstone Authentication

Touchstone@MIT

Welcome, please identify yourself to access MIT services.

Have an MIT certificate?

[Use Certificate - Go](#)

☐ Always login with this

Certificates are your key to secure web services at MIT, (such as Benefits, Request Tracker, SAPweb, and WebSSS) and the preferred way to access MIT servers.

No certificate? Use Kerberos username

Username: @mit.edu

Password: [Login](#)

If you don't have a certificate installed on this machine, you may login using your MIT username (the 8 characters before your @mit.edu email address) and your [Kerberos password](#).

Have Kerberos tickets?

[Use existing tickets - Go](#)

☐ Always login with this

Using your Kerberos tickets to authenticate to MIT Touchstone requires correct browser configuration. This option is useful for Athena and WIN.MIT.EDU users.

6. Click **Open this page in Zoom**

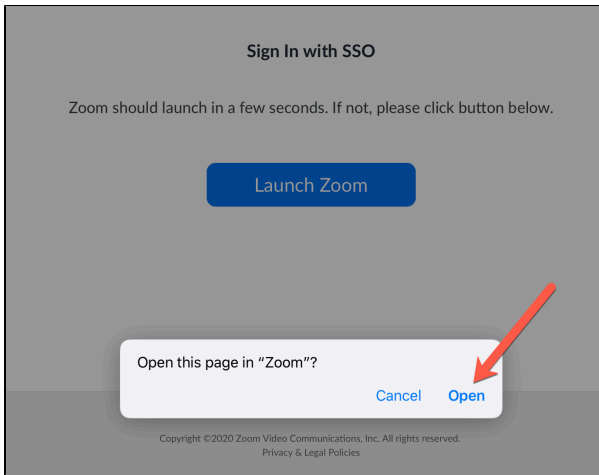

7. Click **Allow/OK** to any permissions that it requests so that Zoom operates smoothly.

See Also

- [Zoom Landing Page](#)